

**TOP DOOR RAIL**

**"S" Type Side Loading Arm**

Drill or drill and tap holes in top of door as shown.

Make 2 1/4" x 1/2" cut-out in top of door as shown. Cut-out must be on the inside of the door.

Install arm using 1/4-20 x 1 1/4" flat head machine screw and 7/8" washer. Install 1/2-13 x 3/4" arm stud and 1/4-20 x 1 1/8" dome head arm adjustment screw. Laterally adjust center of the arm spindle retainer 2 5/8" from hinge edge of door (not including weatherstripping). Center arm in the top rail by adjusting the two 1/4-20 x 1" hex head centering bolts.

After installation of door, attach dress plate with self-threading screws.

**NOTE:** Before attaching dress plate, make certain the three 1/4-20 x 7/8" socket head clamp bar screws with lock washers are tightened securely.

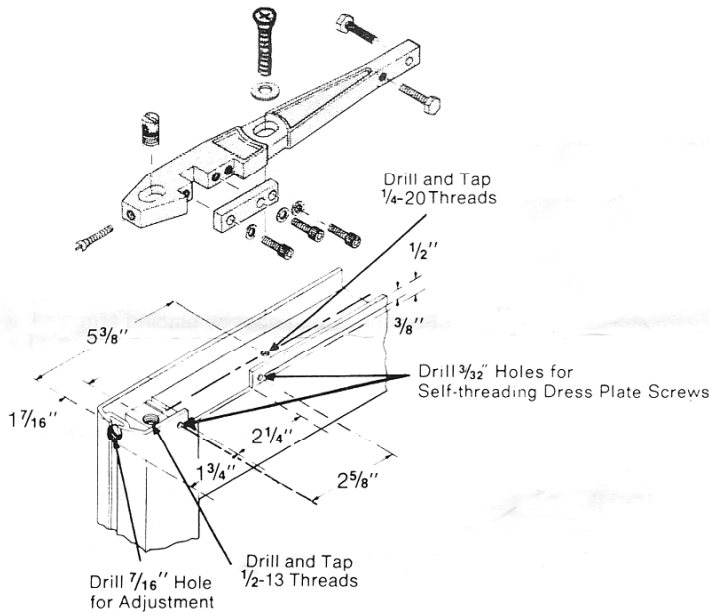

**BOTTOM DOOR RAIL**

**Side Loading**

Drill and tap 1/4-20 holes in bottom rail of door as shown. Install pivot bearing retainer in bottom of door using two 1/4-20 x 5/8" pan head machine screws and lock washers.

Laterally adjust center of pivot bearing retainer 2 5/8" from hinge edge of door (not including weatherstripping) and tighten screws securely.

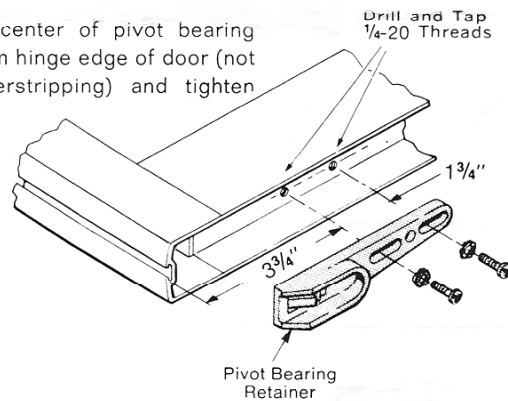

**THRESHOLD MOUNT PIVOT**

Drill hole in threshold as shown. Install threshold adapter nut from top and secure with 3/4-16 hex jamb nut underneath. Install pivot stud and bearing with 1/2-20 hex lock nut as shown and adjust bearing height for proper door clearance and firmly tighten lock nut.

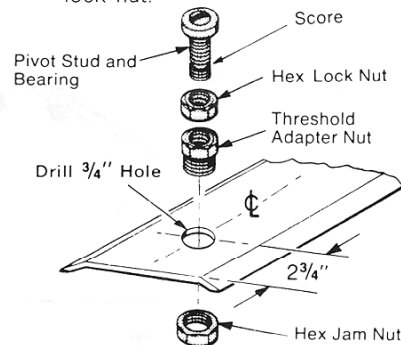

**FLOOR MOUNT PIVOT**

Center pivot base against door jamb on hinge side. Mark and drill 1/4" holes 1 1/2" deep in floor for plastic expansion plugs.

Mount base using #12 x 1 1/4" plastic expansion plugs and #12 x 1 1/4" flat head all-purpose screws.

Install pivot stud and bearing with 1/2-20 hex lock nut as shown, and adjust bearing height for proper door clearance and firmly tighten lock nut.

When using threshold, drill 1 1/4" hole for clearance of pivot base on center line 2 3/4" from hinge end of threshold.

**NOTE:** When threshold is not used, pivot bearing stud must be shortened by sawing off at score 1/2" from bottom.

