

DICTATOR H 1300 Door Damper

With reinforced joint for particularly heavy doors

The progressive breaking action of DICTATOR door dampers damps and slows down the door gently and smoothly, pulls the door into the latch firmly, and keeps the door closed reliably.

The H 1300 door damper has a reinforced joint and a longer roller lever. This gives it a longer life, even when mounted on big and heavy doors.

Progressive damping is particularly important with big doors as the speed of impact increases the further away the door damper is from the door hinge.

The H 1300 door damper is suitable for left and right operating doors.

To make mounting easier and more reliable, special fixing plates for the hook are available, which can be welded onto narrow steel door frames. Large mounting plates are also available for thin-walled steel doors.



Technical Data

Types of doors	left and right operating, overlapping, flush, recessed doors
Closing force	20, 50, 80 or 115 N (measured on the door damper)
Damping characteristics	progressive, adjustable
Damping fluid	silicone oil - independent of temperature
Components included	door damper, hook, screws
Finish	nickel plated
Recommended accessories	"Piccolo" or "Concealed Adjunct" closing spring

Mounting

The installation is done according to the pictures shown below.

Important: the upper edge of the casing should overlap the upper edge of the door by about 1 mm. The hook should be mounted so the rubber roller on the operating lever only just touches the front edge of the hook when closing.

The H 1300 door damper is available with different hooks for overlapping (Ha), flush (Hg) or recessed doors.

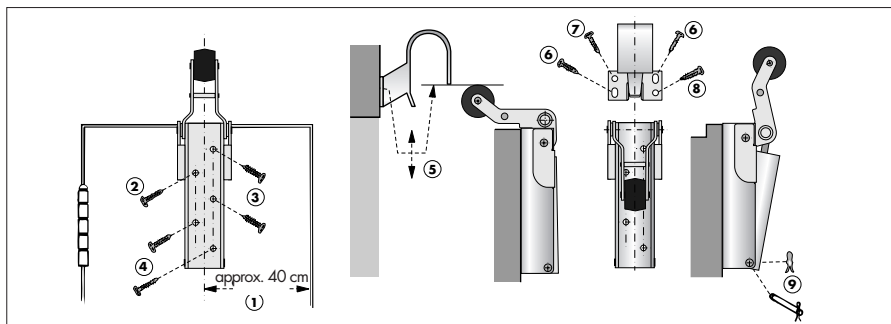

Dimensions

H1300

- with 1009 hook for flush doors
x = 59
- with 1013 hook for overlapping doors
x = 78
- with 1011 hook for recessed doors
x = 39

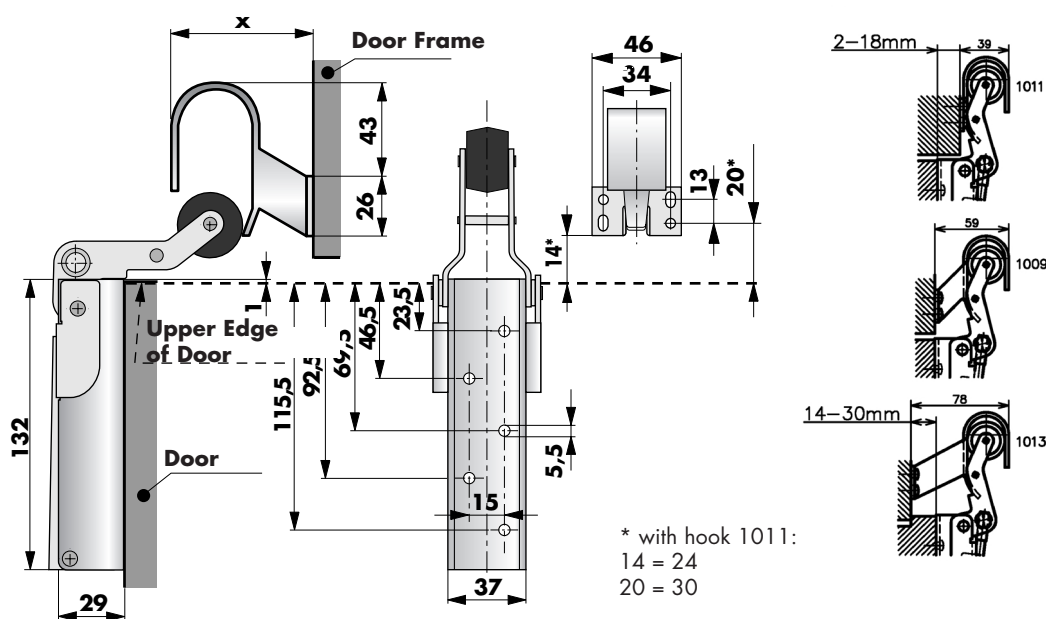

Order Information

Ha 1300 Door damper (for overlapping doors) normal spring	part no. 300 100
Ha 1300 Door damper (for overlapping doors) strong spring	part no. 300 130
Hg 1300 Door damper (for flush doors) normal spring	part no. 300 110
Hg 1300 Door damper (for flush doors) strong spring	part no. 300 140
H 1300 Door damper in other executions	on request

Accessories

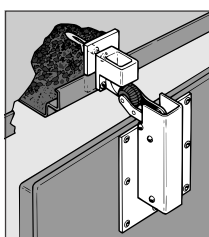

Mounting plate for thin-walled steel doors (to be riveted to door)	part no. 205 213
Mounting plate for narrow steel frames (can be welded)	part no. 205 230

Please find details and diagrams concerning the installation of different mounting plates further on in this catalogue. Please contact us if you have a particularly complicated installation.